

# VAN AIR SYSTEMS



## **Sentinel Series Drain Valves**

**Models MDV-400I and MDV-400L**



*Model  
MDV-400I*



*Model  
MDV-400L*

### **Reliably manage any fluid with ease**

For the most dependable, “round the clock” draining, install Van Air Sentinel Series drain valves.

The Sentinel's heavy-duty ball valve can manage virtually any fluid in a wide variety of uses, including cooling towers, portable installations, process tanks, separators, compressed air dryers and general condensate management.

With a high-quality, two-piece ball valve that resists clogging, the Sentinel provides maximum fluid flow and long-term reliability. Depend on it for nearly any fluid service.



*Choose from a variety of valve sizes and types.*



*Add a level switch to either model for demand drain capabilities.*

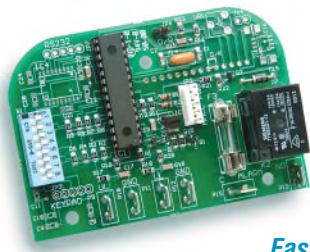

*Easily adjust controls on model MDV-400I to change drain cycle or open times.*

### **Choose the features you need**

Whether you need the simplicity of a basic valve or the flexibility of added features, the Sentinel Series is your solution. Choose from two models, plus different options and accessories to fit the level of adjustment and controls you need.

#### **MDV-400I**

For dependable draining at consistent intervals choose Sentinel model MDV-400I. A **power on LED** and **test button** are handily located on the top cover. To reset the valve, simply adjust the switches on the internal circuit board.

#### **MDV-400L**

If you prefer an **easy-to-use keypad** for convenient timing adjustments and a handy **LCD cycle status readout**, choose Sentinel model MDV-400L. You'll never wonder “when it's set to fire again” with its continuous, clear countdown display of the remaining cycle or drain open times. Added features include **external test and valve fault functions**, both with LCD readout.

The Sentinel Series is also offered with a stainless steel valve, as well as several valve size and voltage options.

### **Zero loss with demand draining**

For draining based on actual liquid levels, the Sentinel can operate in response to a liquid level sensor. When used as a demand drain, the Sentinel drains only liquid, eliminating air or gas loss and noise.

**Sentinel Series Drain Valves – Always on Guard**

# Sentinel Series Drain Valves

## Specifications

115 VAC 50/60 Hz  
 10' power cord w/plug  
 Two-piece brass ball valve  
 1/2", 3/4" or 1" NPT connection  
 Thermoplastic top cover  
 Epoxy powder coated metal base  
 NEMA 4 enclosure  
 Ambient temperature range:  
     0°F to 120°F – MDV-400I  
     10°F to 120°F – MDV-400L  
 Maximum working pressure:  
     brass  
         – 600 psig  
     stainless steel (optional)  
         – 900 psig

**Model MDV-400I:**  
 Power on LED  
 External test button  
 Internal timing adjustment  
 Demand draining capability  
 Cycle time: from 30 min. to 30 hrs.  
 Open time: 5, 10, 15 and 20 sec.

**Model MDV-400L:**  
 LCD cycle status display  
 Demand draining capability  
 External test button  
 External keypad timing adjustment  
 Cycle time: 1 min. to 99 hrs. 59 min.  
 Open time: 1 sec. to 99 min. 59 sec.

## Options & Accessories

12 VDC, 24 VDC, 230 VAC  
 Brass ball valve:  
     1 1/2", 2", 2 1/2" and 3"  
 Stainless steel ball valve:  
     1 1/2" and 2"  
 Alarm contact for remote indication  
     of fault mode  
 High liquid level sensor  
 Low liquid level sensor

*Actuator w/standardized ISO mounting  
 pad sold separately*

## Dimensions and Weights – Standard Brass Ball Valves

Inches (cm) and Pounds (Kg)

VALVE CONNECTION SIZE	A	B	C	D	APPROX. WEIGHT
1/2 NPT	6.5 16.5	6.8 17.3	6.0 15.2	2.6 6.6	8.2 3.7
3/4 NPT	6.7 17.0	6.8 17.3	6.0 15.2	3.0 7.6	8.4 3.8
1 NPT	7.2 18.3	6.8 17.3	6.0 15.2	3.3 8.4	8.8 4.0

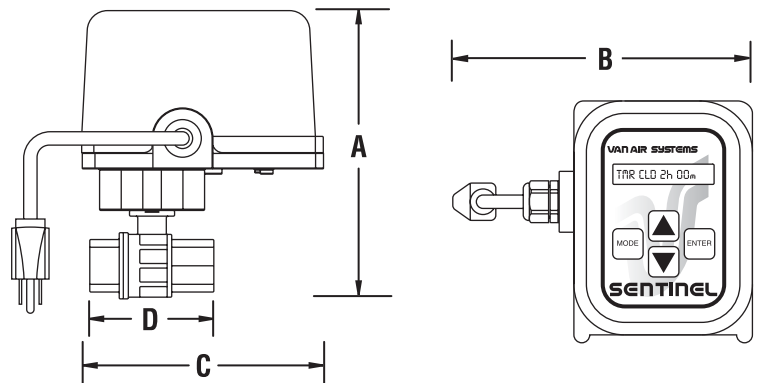

## How to Order

To order, add the appropriate letter to the base model number and list voltage, valve material and connection size:

MDV-400I = **Internally adjustable** model w/external test button

MDV-400L = **LCD display** version w/external membrane keypad

Distributed by: Air & Vacuum Process, Inc.  
 Phone (281)866-9700  
 Toll Free (866)660-0208  
 Fax (281)866-9717  
 sales@airvacuumprocess.com

# VAN AIR SYSTEMS



2950 Mechanic Street, Lake City, PA 16423 USA  
 Phone: (814) 774-2631, (800) 840-9906  
 Fax: (814) 774-0778  
 E-mail: vanair@vanairsystems.com  
 www.vanairsystems.com